

Steps for Drawing a Room in Perspective

Supplies: 9"x12" Drawing paper, pencil, eraser, ruler

1. Using your ruler, draw an X from corner to corner

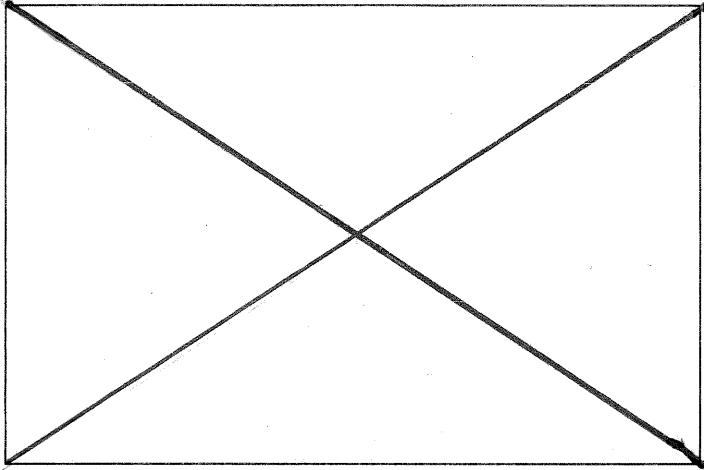

2. Draw in your Vanishing Point

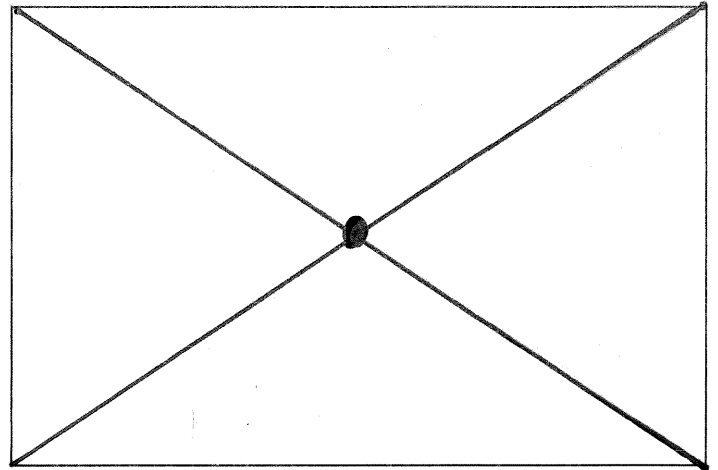

3. Draw in your horizon line as a dotted line.

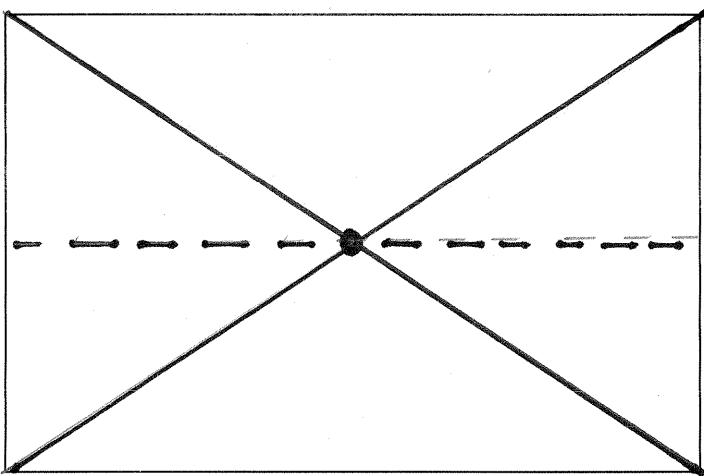

4. *Back wall* (this a rectangle)– Begin with a vertical line between two X lines

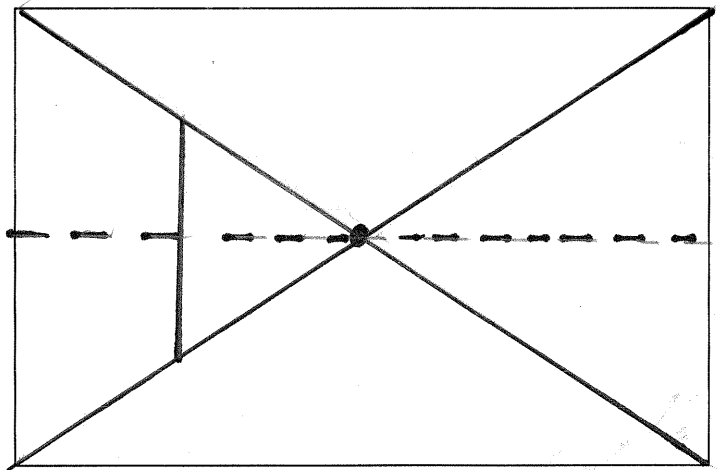

4. *Back Wall*-Begin a horizontal line where your vertical line ended. These lines are perpendicular

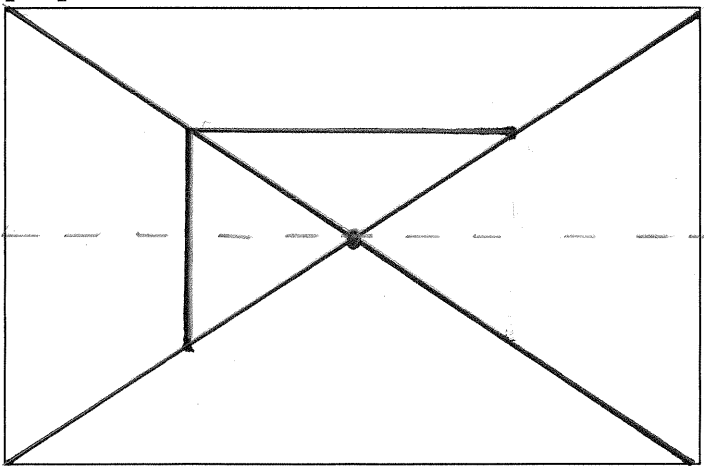

4. *Back Wall*-Begin another vertical line where your last horizontal line ended. These lines are perpendicular

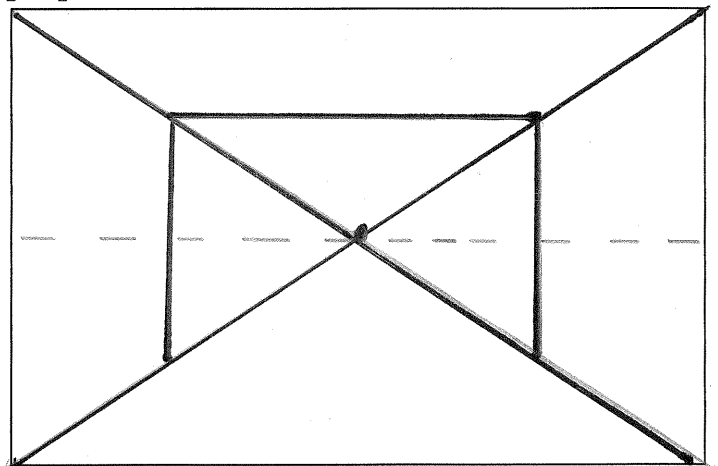

4. *Back Wall*-Complete your square by drawing your last horizontal line

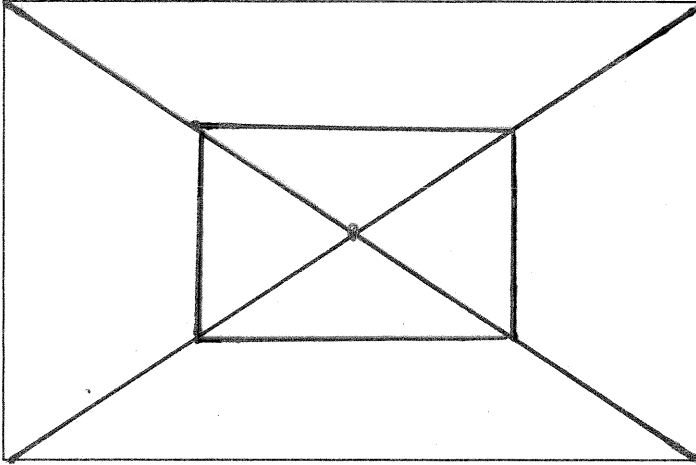

4. *Back Wall*-Erase the X in the interior or inside the back wall. Do not erase your vanishing point

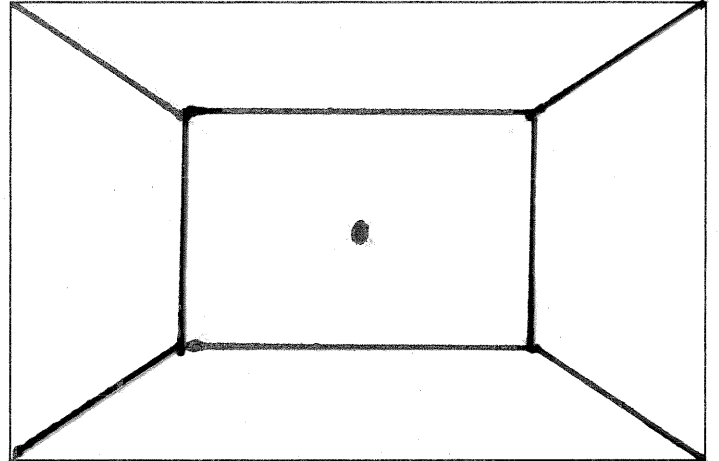

5. *Door*-Draw a vertical line

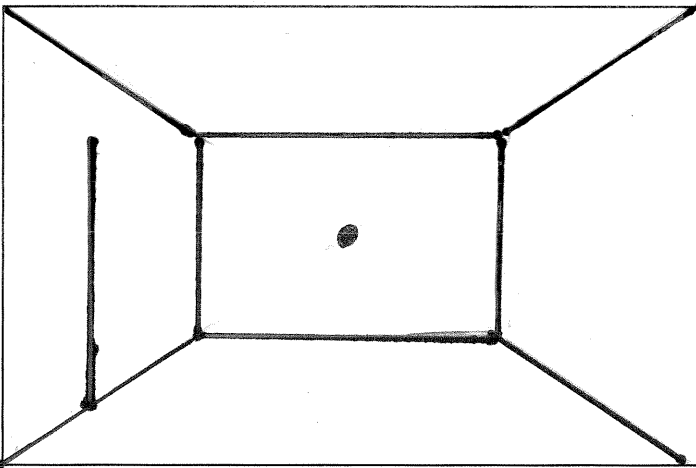

5. *Door* - Draw a line from the top of the line to the vanishing point

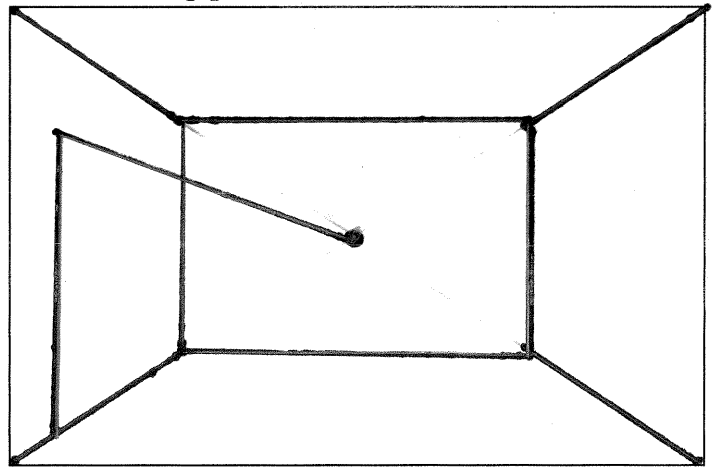

5. *Door*-Draw a parallel vertical line

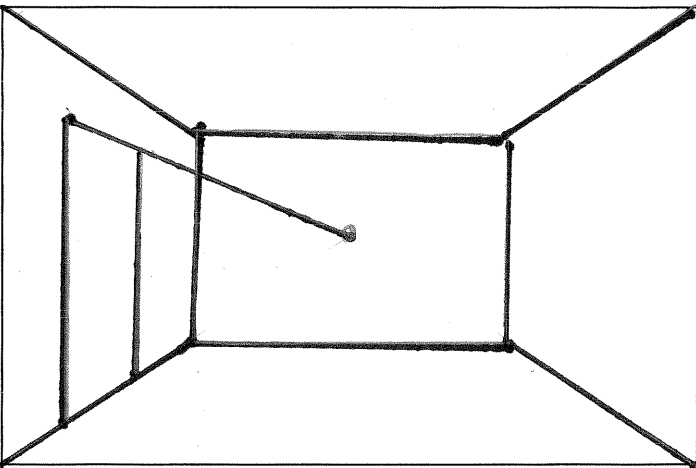

5. *Door* - Erase line from edge of door to vanishing point

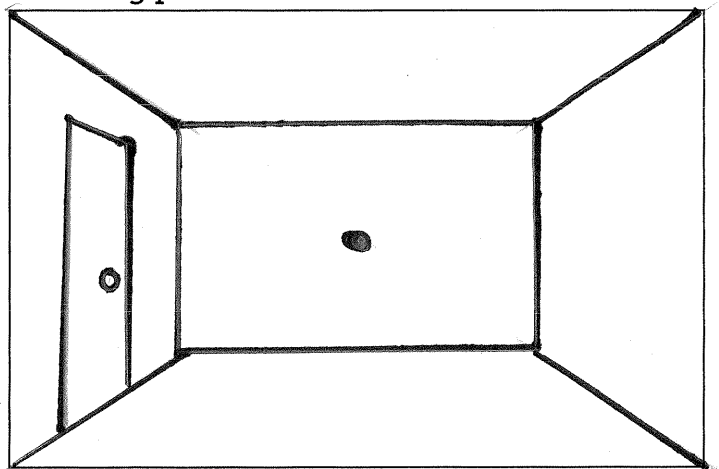

6. *Door Frame* – Follow same step for creating a door, but draw around the door.

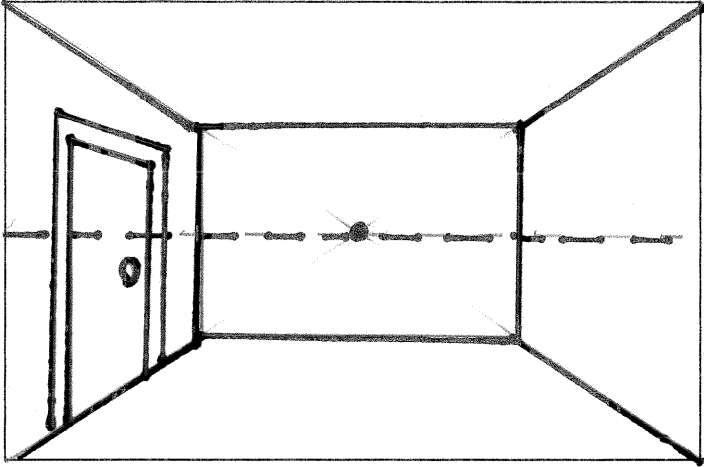

7. *Window* – Draw a parallel line that is a little above and below the horizon line near the edges of the paper

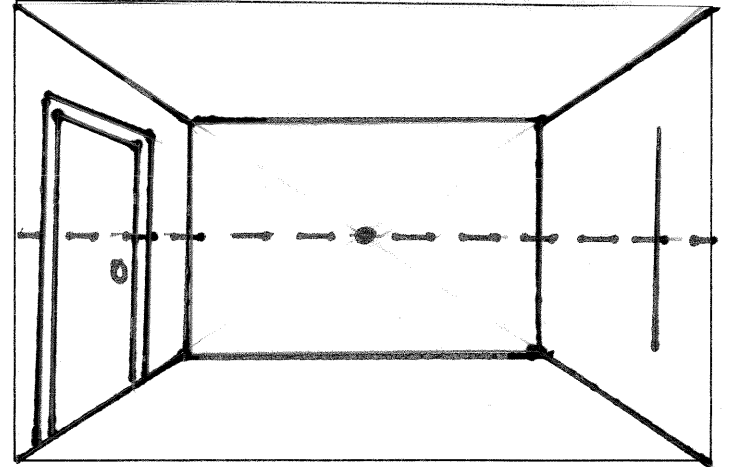

7. *Window* – Connect the top of line to vanishing point.

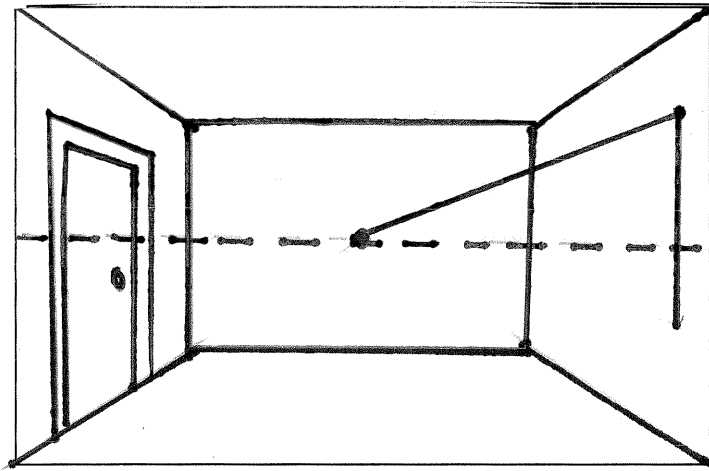

7. *Window* – Connect bottom of line to vanishing point.

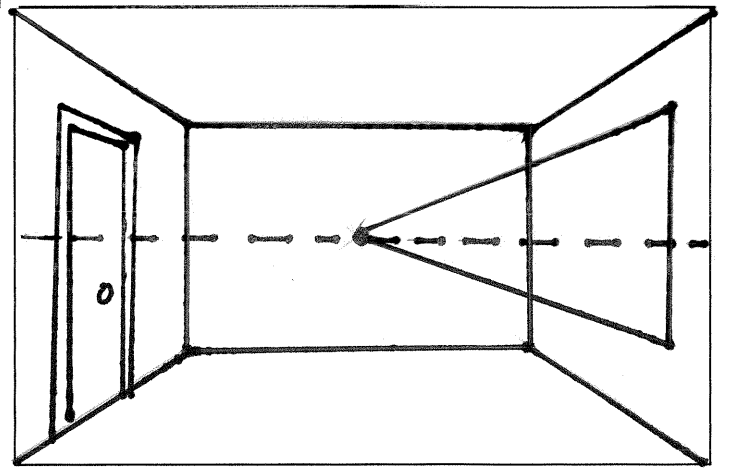

7. *Window* – Draw parallel vertical line for one window.

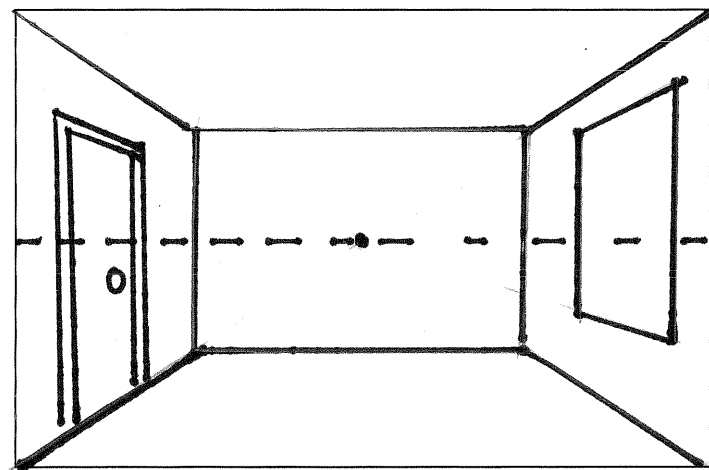

7. *Bed* – Draw a rectangle as shown below.

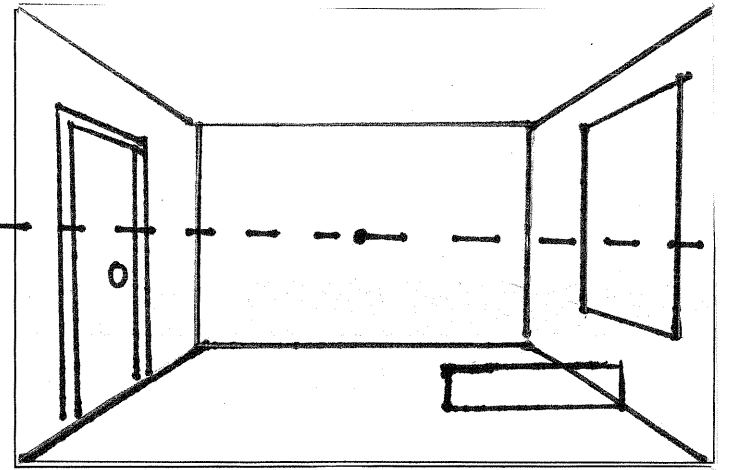

7. Bed - Erase interior line inside rectangle

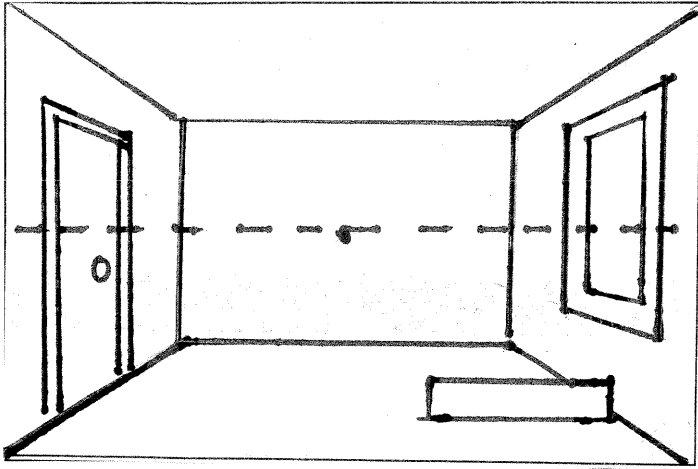

7. Bed - Connect both top corners and bottom out side corner to the vanishing point (3 lines)

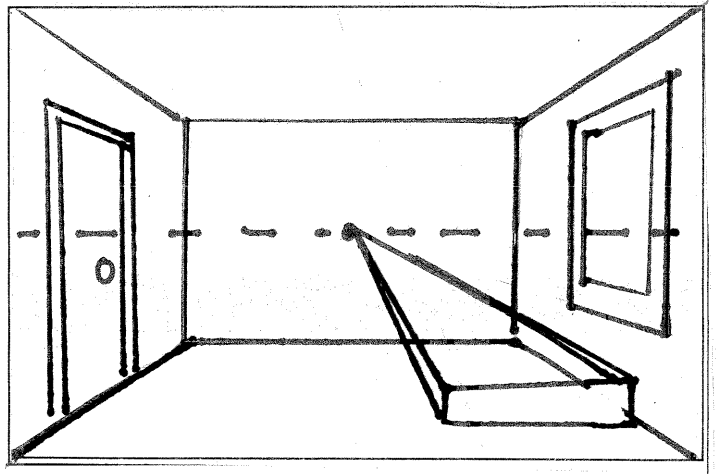

7. Bed - Erase interior lines

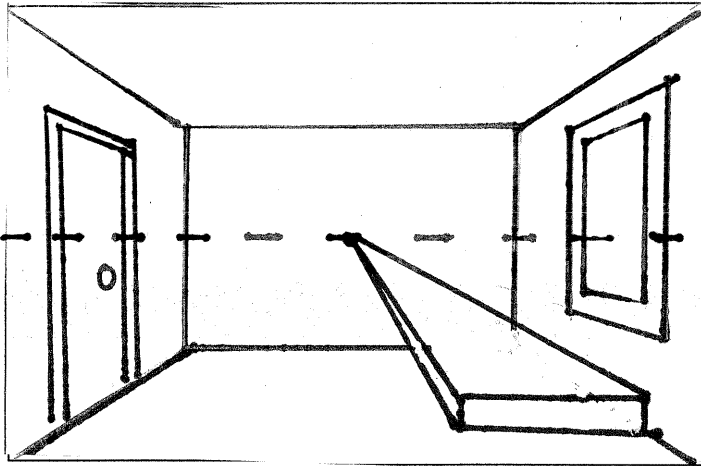

7. Bed - Draw parallel verticle line

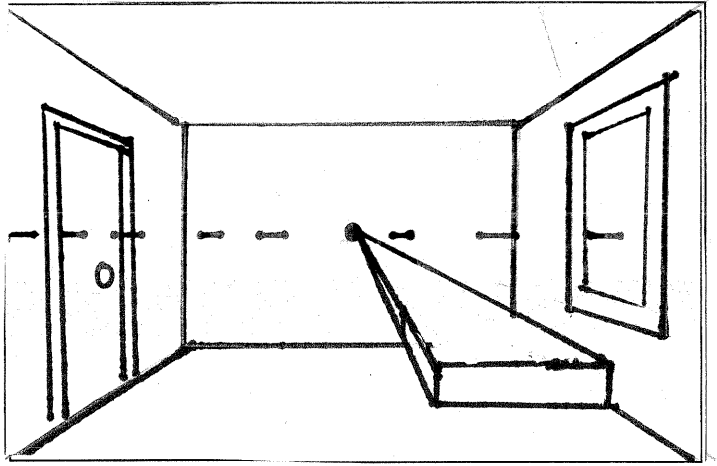

7. Bed - Draw verticle line where last ended

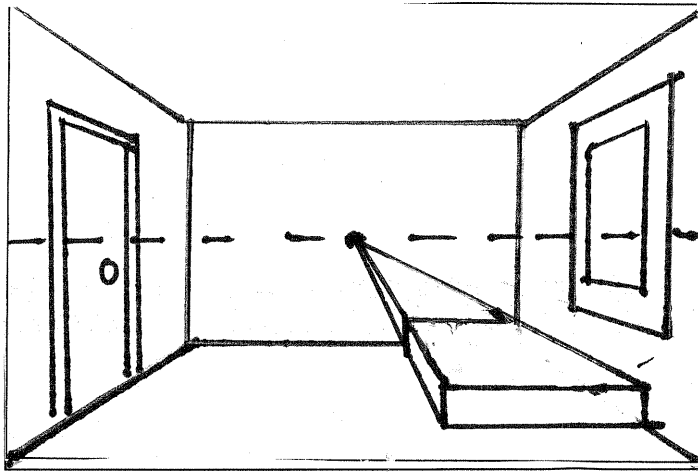

7. Bed - Erase lines going to vanishing point and draw head board

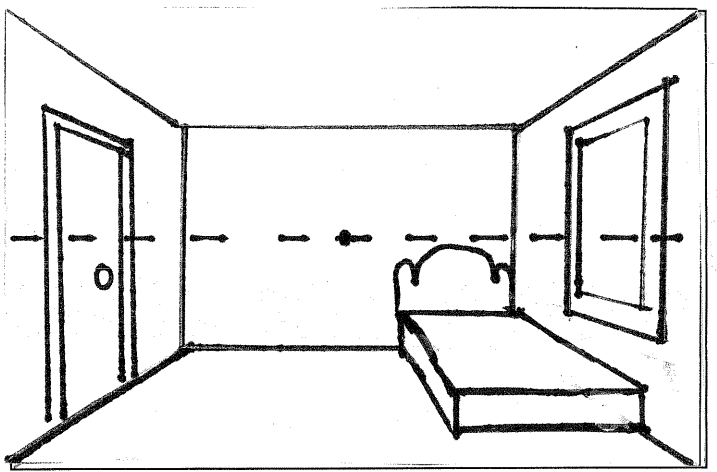

8. *Floor*- Draw evenly spaced points where the back wall meets the floor.

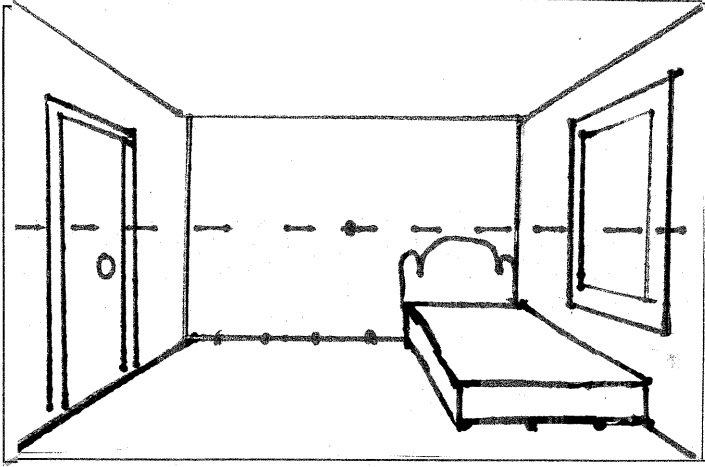

8. *Floor*- Line up each point with the vanishing point and draw a line. Your ruler will move like the hand of a clock.

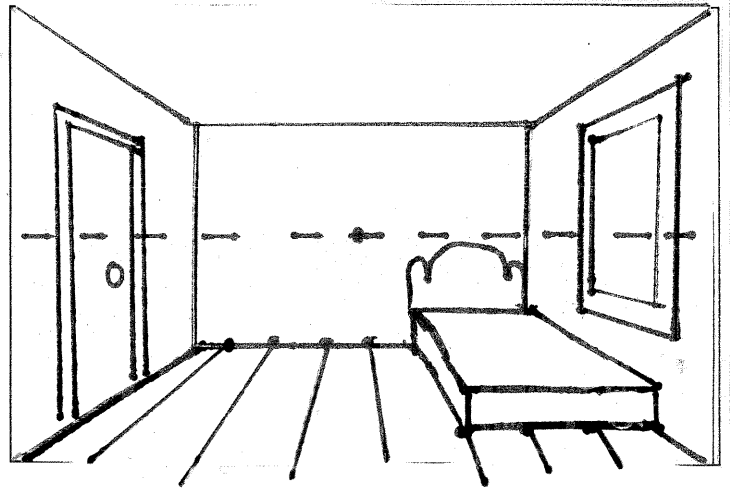

8. *Floor Tiles*- Draw vertical lines to make floor tile. These lines should get farther apart as you get closer to the bottom edge of the paper.

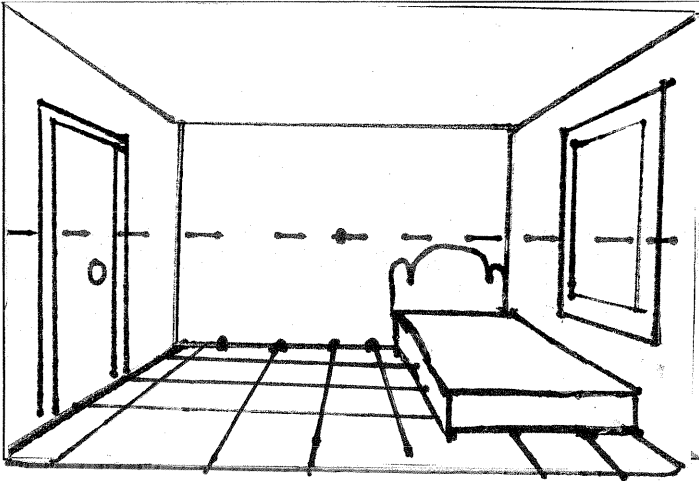

8. *Wood Floor*- Draw horizontal lines between every other vertical line.

